

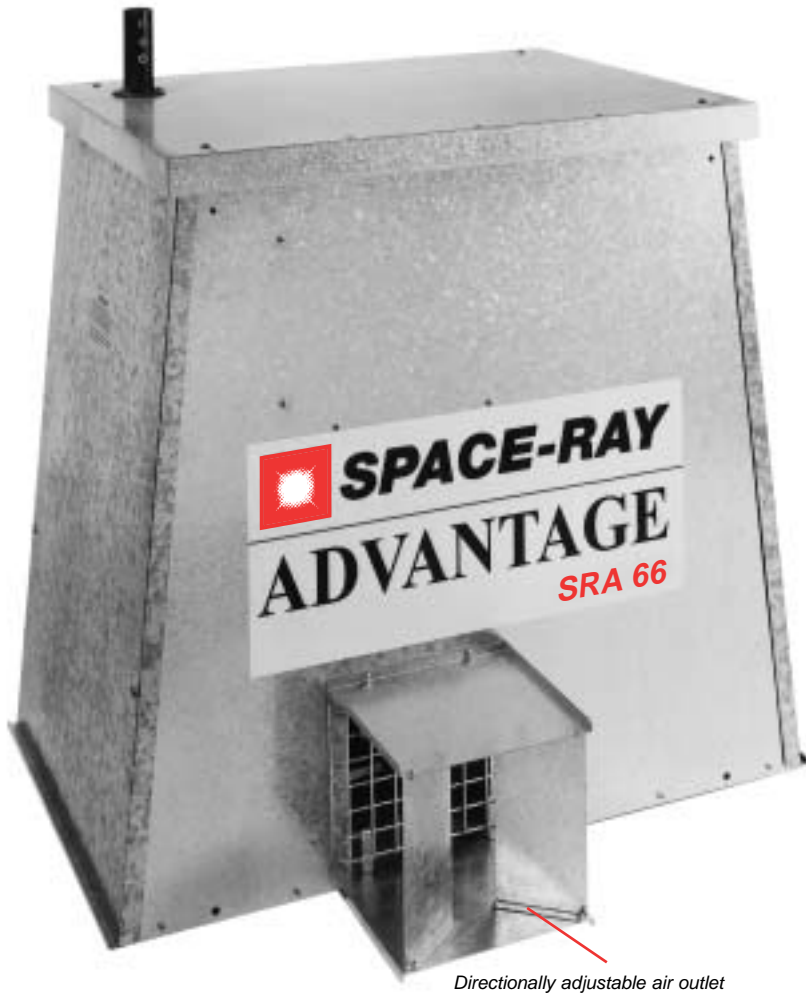

SPACE-RAY

The **ADVANTAGE** Poultry Air Heater

More heat at less cost!



Advanced UK design. UK designed and manufactured air heater for poultry applications.

Dual application - inside and out. Inside or outside mounting using the same heater for either application.

Very competitively priced. Outstanding value in today's competitive market place.

Approved to full CE standard. Meets all relevant European directives.

No hassle maintenance. Easy access to both burner and controls.

Twin solenoid valve, flame failure and air sensor switches – all part of the package.

Aadjustable rate - 4 heat options. 66kW to 44kW depending on your application, house size & needs.

Gas fired - uses either propane or natural gas.

External diagnostic monitoring lights - mount the light bar to show from any angle.

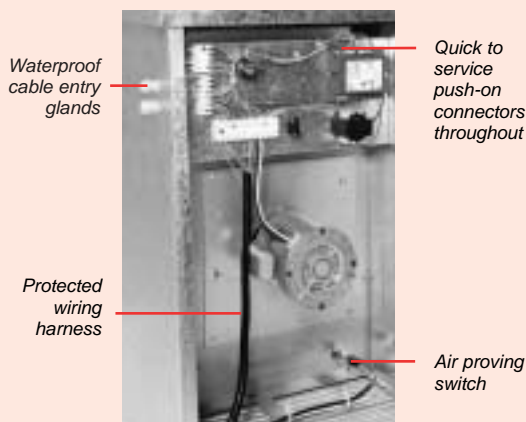

Powerful blower driven by a heavy duty electric motor with sealed ball bearings

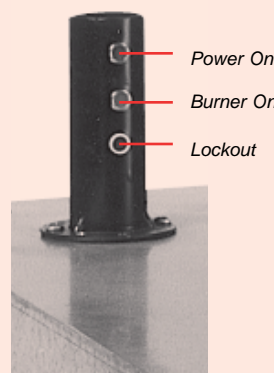

Maintenance-friendly, rotatable external diagnostic lights

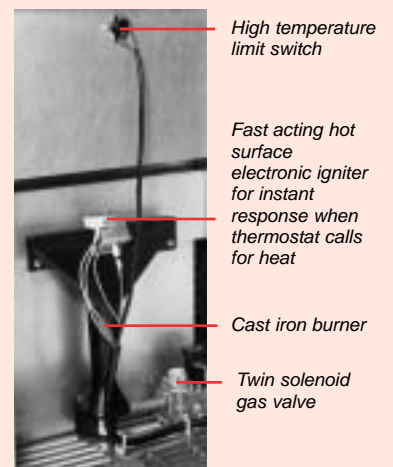

Energy efficient ignition system



The ADVANTAGE

SPECIFICATION GUIDE

Heat input	Model		SRA66	SRA59	SRA51	SRA44
		kW	66.0	59.0	51.0	44.0
		Kcal/h	56797	50769	43885	37861
		Btu/h	225258	201367	174063	150172
Gas Consumption per hour	LPG	kgs	4.75	4.25	3.67	3.16
		litres	9.30	8.31	7.19	6.20
		lbs	10.47	9.37	8.09	6.96
	Nat Gas	MJ/hr	237.6	212.4	183.6	158.4
		m ³ /h	6.17	5.52	4.77	4.11
		ft ³ /h	218	194	168	145
Dimensions (casing)	Depth (D)	530mm				
	Width (W)	780mm				
	Height (H)	765mm				
Heater weight		45 kg				
Air Flow		28.33m ³ /min (1000 cfm)				
Ventilation		Refer to installation instructions				
Motor		248W (1/3 H.P.)				
	Current rating		3.0A			
Fused		10.0A				
Ignition		Hot surface igniter				
Burner		Atmospheric – Heavy duty cast iron				
Mounting Kit	Inside House		Adjustable outlet vent / suspension hooks			
	Outside House		Adjustable outlet vent / insulated duct / mounting kit			
Gas Connection	R-1/2	1/2 in. BSP External				
Gas Type		Propane at 37.0mbar (15.0 in. w.g.) supply pressure				
		Nat Gas at 20.0 mbar (8.0 in. w.g.) supply pressure				

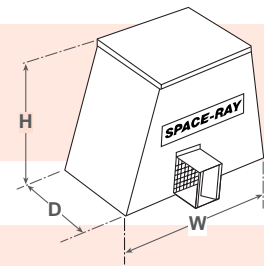

OUTSIDE MOUNTING KIT

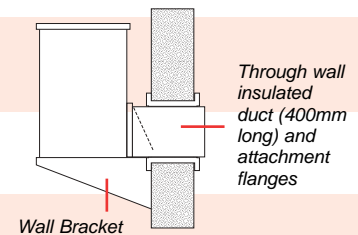

We reserve the right to alter specifications without prior notice.



SPACE-RAY – ALSO WORLD FAMOUS FOR CANOPY BROODERS

GAS FIRED PRODUCTS (UK) LTD
Chapel Lane, Claydon, Ipswich
Suffolk IP6 0JL, England
Tel: 01473 830551 Fax: 01473 832055
E-mail: info@spaceray.co.uk



Made in the UK