



SPACE-RAY

The

ADVANTAGE

Poultry Air Heater

- Four model ratings:
 - SRA66 – 66kW (225,000 Btu)
 - SRA59 – 59kW (201,000 Btu)
 - SRA51 – 51kW (174,000 Btu)
 - SRA44 – 44kW (150,000 Btu)
- Typical SRA66 coverage - 465m² (5,000 ft²)
- 'Hot' Surface Ignition for maximum Reliability and Efficiency
- Quality Heavy Duty Burner - Cast Iron for maximum working life
- Easy to maintain - Full component access to keep costs low
- Propane and Natural Gas
- Made in Britain by SPACE-RAY
- CE Approved

Gain the
ADVANTAGE
with
SPACE-RAY

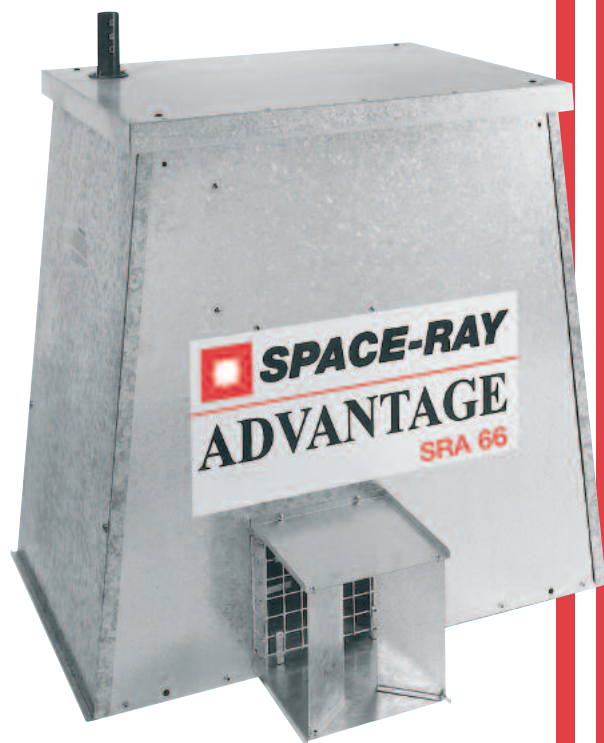

SPACE-RAY



SPACE-RAY

SPECIFICATION GUIDE - ADVANTAGE				
MODEL	SRA66	SRA59	SRA51	SRA44
INPUT RATING - Kw	66.0	59.0	51.0	44.0
Btu/h	225,000	201,000	174,000	150,000
GAS CONSUMPTION / hour				
LPG - Kgs	4.75	4.25	3.67	3.16
Litres	9.30	8.31	7.19	6.20
Nat Gas – MJ/hr	237.6	212.4	183.6	158.4
m ³ /h	6.17	5.52	4.77	4.11
DEPTH mm - D	530mm			
WIDTH mm - W	780mm			
HEIGHT mm - H	765mm			
WEIGHT Kg	58kg			
AIR FLOW	28.33 m ³ /min (1000cfm)			
GAS CONNECTION	R - 1/2			
SUPPLY PRESSURE	Propane – 37.0 mbar Natural Gas – 20.0 mbar			
ELECTRICAL SUPPLY	230v~50Hz 460W, Fuse Internally 10A			
IGNITION	Hot Surface Igniter			
MOUNTING KITS	Adjustable outlet vent/suspension hooks			
Inside House	Adjustable outlet vent/insulated duct/mounting kit			
Outside House				

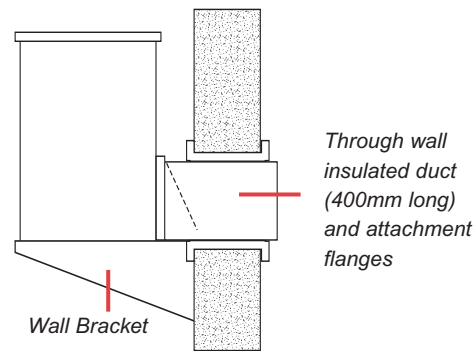
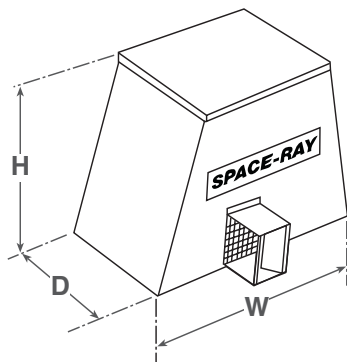

SPACE-RAY

For more information contact:

Gas Fired Products (UK) Ltd, Chapel Lane, Claydon, Ipswich, Suffolk IP6 0JL UK
Telephone: (01473) 830551 Fax: (01473) 832055 Email: info@spaceray.co.uk Website: www.spaceray.co.uk

We reserve the right to alter specifications without prior notice.

FACTORIES: ■ IPSWICH, ENGLAND ■ CHARLOTTE, N.C., U.S.A.